



TUFFscreens

8' x 8' Infield Screen Assembly

STEP 1:

Assemble frame and base using hardware provided.

STEP 2:

For maximum frame stability, face the large 1" hole opening on the steel pipes towards the interior of frame. The nut and washer are attached through the large hole opening (Figure A).

STEP 3:

Slip pillowcase net over frame and secure bottom sewn rope borders to steel tubing using zip ties.

STEP 4:

Assemble pre-cut foam pads as shown. Use the extra Pad B (48" L) to cut fill-in sections for any remaining gaps.

STEP 5:

Starting at one end, attach vinyl banner to foam padding using zip ties. Seam to be located on interior of frame.

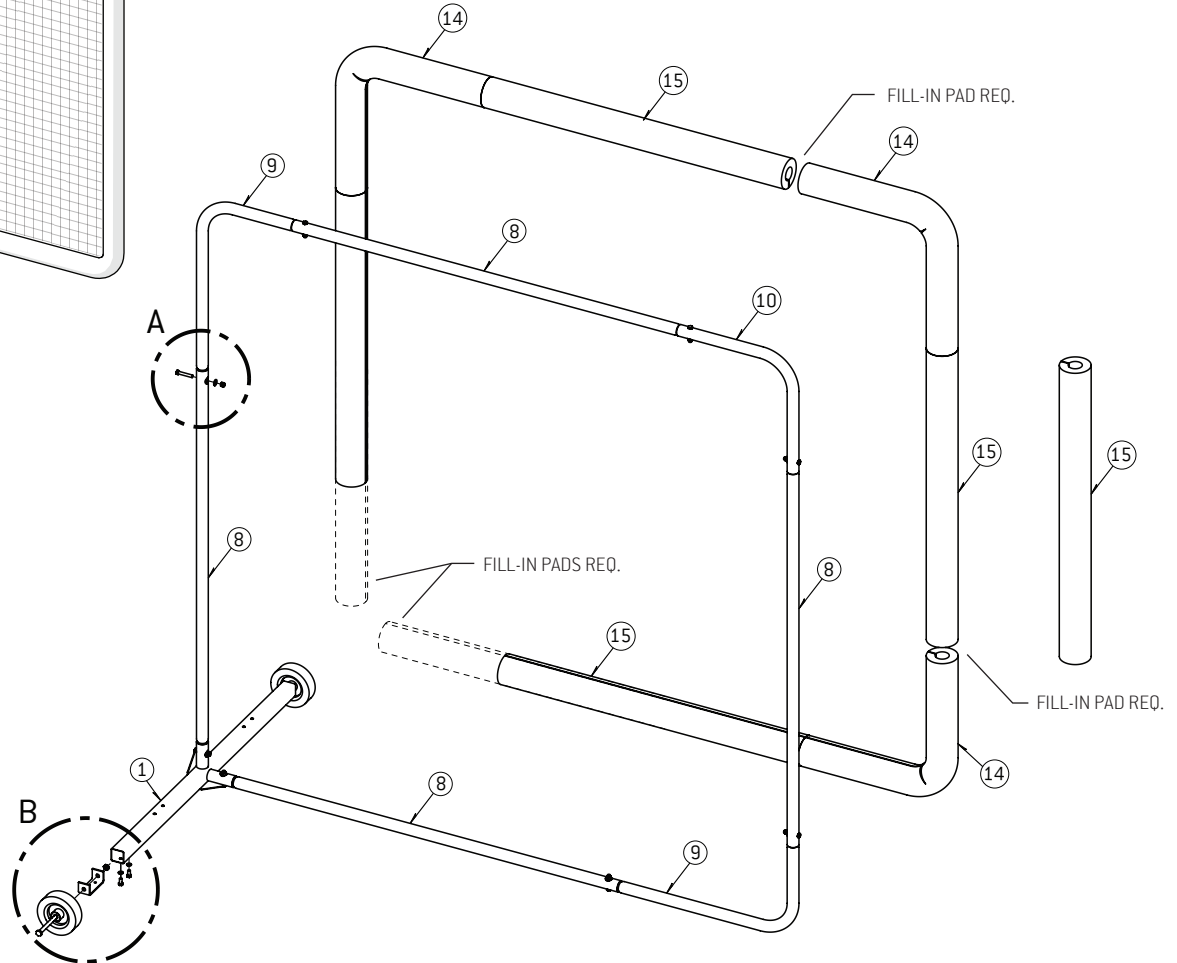
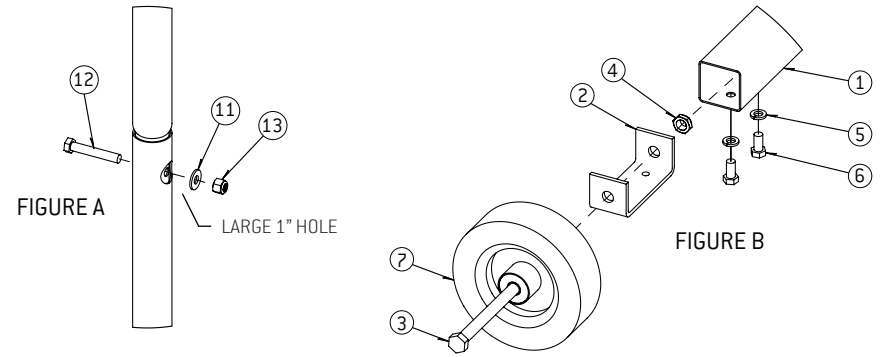
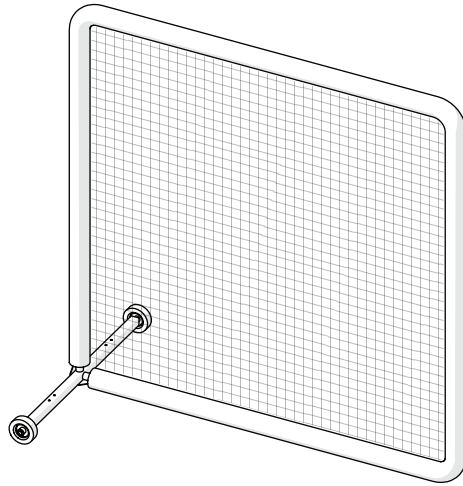

ITEM NO.	DESCRIPTION	QTY.
1	INFIELD SCREEN BASE	1
2	WHEEL KIT AXLE BRACKET	2
3	1/2"-13 X 7 1/2" HEX BOLT (PARTIAL THREAD)	2
4	1/2"-13 JAM LOCK NUT	2
5	3/8" X .68" OD SPLIT LOCK WASHER	4
6	3/8"-16 X 3/4" HEX BOLT	4
7	6" X 2" FLAT FREE TIRE	2
8	1.66" X 16 GA X 65" L TUBE, SWAGED	4
9	1.66" X 16 GA X 29.0625" L TUBE, SWAGED	2
10	1.66" X 16 GA X 34.0625" L TUBE, SWAGED	1
11	5/16" X .875" OD WASHER	8
12	3/8"-16 X 2 1/2" HEX BOLT (PARTIAL THREAD)	8
13	3/8"-16 LOCK NUT	8
14	PAD A (43" L W/ (1) CENTER CUT)	3
15	PAD B (48" L)	5
--	8' X 8' INFIELD SCREEN NET	1
--	TUFF FRAME VINYL BANNER COVER	1
--	8" ZIP TIE (NOT SHOWN)	120



BEACON ATHLETICS

THE ULTIMATE BALLFIELD RESOURCE™

800-747-5985

BeaconAthletics.com